

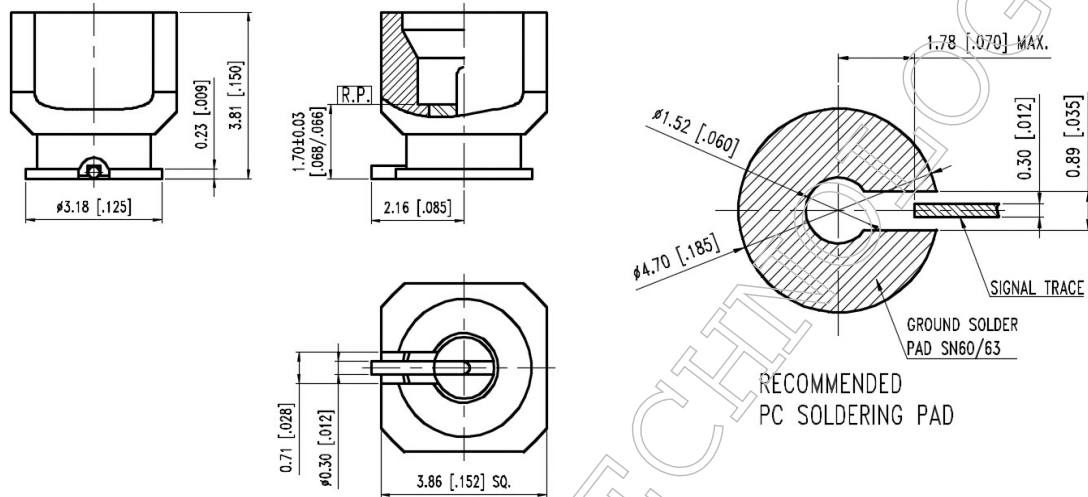

■ **Outline Dimension Drawing**

Dimensions: mm[inch]



■ **Material Specification**

| Description | Material | Plating |
|-------------|-----------------|---------|
| Body | Stainless steel | Gold |
| Contact | BeCu | Gold |
| Dielectric | Torlon | Yellow |
| | | |
| | | |
| | | |
| | | |
| | | |

In the effort to improve our products, we reserve the right to make changes judged to be necessary

■ Electrical Specification

| Description | | | Description | | |
|---------------------------------|-----|-----------|--------------------------|------|-----------------|
| Impedance | 50 | Ω | Insulation Resistance | 5000 | M Ω Min. |
| Frequency | 18 | GHz | Inner Contact Resistance | 4 | m Ω Max. |
| VSWR | 1.5 | Max. | Outer Contact Resistance | 2 | m Ω Max. |
| Insertion Loss | 0.5 | dB Max. | | | |
| Voltage Rating | 325 | Vrms Max. | | | |
| Dielectric Withstanding Voltage | 500 | Vrms Max. | | | |

■ Mechanical Specification

| Description | | |
|--------------------------|-----|--------------|
| Engagement Force | | |
| Smooth Bore | 2.5 | lbs. Max. |
| Disengagement Force | | |
| Smooth Bore | 1.5 | lbs. Min. |
| Connector Durability | 500 | matings min. |
| Center Contact | | |
| Axial Force-Mating End | 3.5 | lbs. |
| Axial Force-Opposite End | N/A | lbs. |
| Weight | N/A | g |

■ Environmental Specification

| Description | | |
|------------------|-----|----|
| Temperature Min. | -65 | °C |
| Temperature Max. | 165 | °C |
| Hermetic Seal | N/A | |

In the effort to improve our products, we reserve the right to make changes judged to be necessary